



December 1, 2016

Jonathan and Bobby Harmison
607 Maple Street
Overbrook, Kansas

TCS #2016.048

Mr. and Mrs. Harmison

Per your request an inspection of the basement support columns was performed on Tuesday November 29, 2016. The following conditions were observed.

The basement is separated into two areas, the west area has a concrete floor and the east area has an ungraded gravel floor. The basement columns in the west area have the concrete around them. The basement columns in the east area have the gravel around them. All of the columns have signs of rust at the base; some of the columns have failed due to the rust.

The following are corrective actions that shall be taken. There is a Basement Layout plan attached to reference for the location of the columns. The columns will be referenced by the grid lines they are located on.

- E-2, G-2, L-2; remove the gravel from around the column(s).
- G-3; remove the gravel from around the column, replace the steel pipe column.
- B-4; remove the gravel from around the column.
- D-4, E-4, H-4; remove the gravel from around the column(s), replace the steel pipe column.
- M-4; remove the gravel from around the column.
- A-5, A-6, A-7; remove, replace the steel pipe column.
- A-8; replace the steel pipe column.
- C-8, D-8, G-8; no corrective action required.

The following are corrective actions required immediately;

- B-4; replace steel pipe column with 4x4 ACQ treated post.
- D-4, E-4, H-4; replace steel pipe column with 4x4 ACQ treated post.
- A-5, A-6, A-7, A-8; replace steel pipe column with 4x4 ACQ treated post.
 - replace with 3 ½" dia. adjustable steel pipe column with a 8" x 12" x ½" base plate.

The following are permanent corrective actions;

- B-4; replace steel pipe column with 3 ½" diameter adjustable steel pipe column.
- D-4, E-4, H-4; replace steel pipe columns with 3 ½" diameter adjustable steel pipe columns.
- A-5, A-6, A-7, A-8; replace steel pipe column with 3 ½" diameter adjustable steel pipe column with an 8" x 12" x ½" base plate.

Due to the rust that is present on all steel pipe columns it is recommended that the remaining pipe columns shall be replaced at some time.

Sincerely

K. Hector Girardin

TechCAD Services LLC

hector@techcadservices.com

785 249 3884

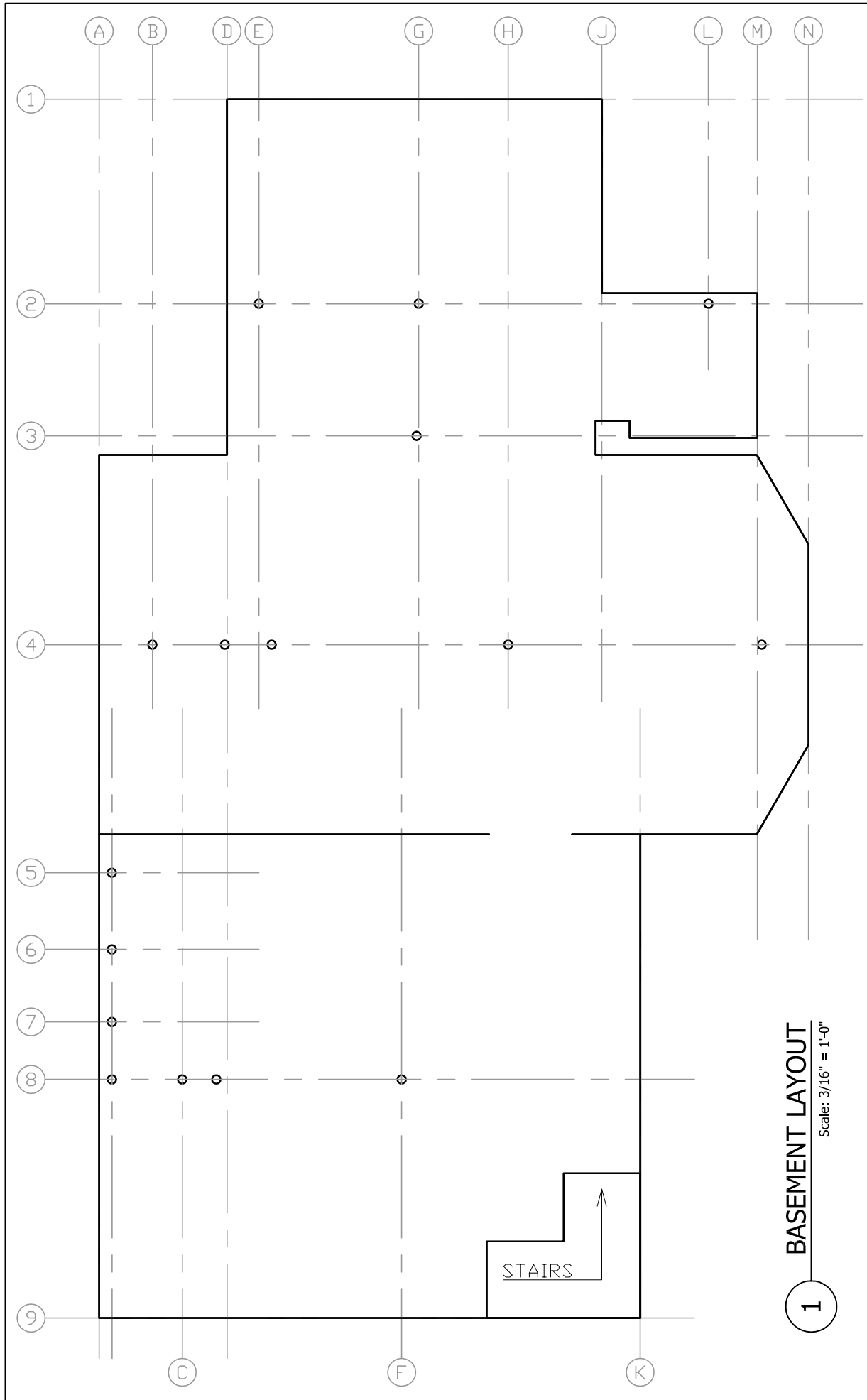

1 BASEMENT LAYOUT
Scale: 3/16" = 1'-0"



NO	DATE	DESCRIPTION	BY	APP

SHEET TITLE: BASEMENT LAYOUT
PROJECT: JONATHAN and BOBBY HARMISON 607 MAPLE STREET OVERBROOK, KS
REF:
PROJ NO: 2016.048
DATE: Nov. 30, 2016
DRAWN BY: KH GIRARDIN
CHK'D BY:
DRAWING: S-101

REVISIONS

607 Maple Street, Overbrook, Ks

PHOTO LOG

East Area (Looking East)



East Area (Looking Southeast)



607 Maple Street, Overbrook, Ks

PHOTO LOG

East Area (Looking South)



Column E-2



607 Maple Street, Overbrook, Ks
PHOTO LOG

Column G-2



Column L-2



607 Maple Street, Overbrook, Ks
PHOTO LOG

Column G-3



Column B-4



607 Maple Street, Overbrook, Ks
PHOTO LOG

Column(s) D-4, E-4



Column H-4



607 Maple Street, Overbrook, Ks
PHOTO LOG

Column M-4



Column(s) A-5, A-6, A-7 (background at wall)



607 Maple Street, Overbrook, Ks
PHOTO LOG

Column(s) A-8, C-8, D-8, G-8

